



Complete CAD/CAM Solutions



DEL CAM

- A wholly-owned, independently-operated subsidiary of Autodesk
- 150 offices and partners in over 80 countries
- More than 800 employees
- The world's largest CAM development team*
- 50,000 customers worldwide
- 40 years of experience developing CAD/CAM solutions
- Headquartered in a purpose-built 63,000 sq. ft. facility in Birmingham, UK

PRODUCTS

Each product can be used independently to solve a specific customer's problem, providing the perfect point solution, such as adding programming for high speed machining or extending an existing CAD capability to support more complex 3D shapes. Offering a full suite of products enables Delcam to combine any number of individual elements within an integrated package to meet a customer's needs. Tailoring solutions in this way ensures that Delcam can match a company's needs today but also grow to match their needs tomorrow.

Not all of Delcam customers are large. The software has also been supplied to many independent designers, toolmakers and mouldmakers. Special efforts are made to develop systems for these smaller companies to give them powerful solutions to their manufacturing problem at a realistic price.

ArtCAM



ArtCAM is an artistic CAD/CAM software range used by hobbyists and large multi-nationals to create high quality, decorative 2D or 3D products from artwork, quickly and efficiently.

Autodesk Footwear



Autodesk Footwear is our Custom Orthotic Insole and Crispin production footwear software solutions. We provide software for the creation of the complete custom shoe; from last creation, complex upper and sole design to custom insoles. Our technology and services help both our new and existing customers find the best digital solution available. And our aim is to provide more investment in products and services for the footwear and insole creation market.



THE QUEEN'S AWARDS
FOR ENTERPRISE:
INNOVATION
2010



THE QUEEN'S AWARDS
FOR ENTERPRISE:
INTERNATIONAL TRADE
2011

PowerSHAPE

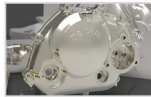

PowerSHAPE integrates surface, solid and triangle modelling. Design complex 3D models from scratch, or prepare imported data for manufacture, quickly, simply and accurately.

FeatureCAM

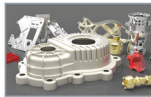

FeatureCAM is a unique CAM system that uses feature-based and knowledge-based technologies for automated machining, minimising programming times for mills, lathes, turn/mill, and wire machines.

PartMaker



PartMaker applies a Patented Visual Programming approach to automate the programming of multi-axis Swiss-type lathes and turn-mill centres.

PowerMILL



PowerMILL is the world's leading specialist NC CAM software for the manufacture of complex shapes, providing advanced machining strategies to minimise machining time and maximise finish quality.

PowerINSPECT



PowerINSPECT provides a complete CAD-based inspection solution with easy-to-use reporting. It accepts measurement data from all types of devices, including manual and CNC/DCC CMMs, portable arms, optical measuring devices, and CNC machine tools.

Delcam for SolidWorks

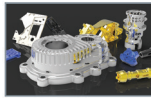

Delcam for SolidWorks is a completely integrated CAM system for SolidWorks, offering solutions for 2D and 3D milling, 5-axis simultaneous machining, high-speed milling, turning, turn/mill, and wire EDM.

GRADUATE & PLACEMENT PROGRAMME

Our graduate and placement programmes run side by side at Delcam to ensure that all new starters get the training and support they need at the start of their careers.

We start by providing intensive training; for developers that will be in Delcam's primary programming language, C++, and for engineers and marketers it will be in Delcam extensive range of CAD/CAM products.

Following the initial training courses, you will begin a series of rotations around the different teams at Delcam. Developers will gain experience working in up to five different development teams, growing your knowledge and expertise by working alongside experienced Delcam software engineers across our broad range of CAD/CAM products.



"Delcam's continued growth has provided opportunities to develop my ideas into world class products."

Colin Jones
PowerMILL Development Manager

Engineers and marketers will get the opportunity to rotate around the different departments at Delcam covering Training, Support, Professional Services, and Product Marketing, again maximising the range of skills you will learn during your time with us.

One year placements at Delcam work in exactly the same way, as for us it's just the first step in what we hope will become a future career at Delcam. Even our summer internships go through the same training and although

there is only time for one rotation, we often offer undergraduates the opportunity to return the follow year to continue their development at Delcam.



"Having first joined Delcam as a placement student, it is great to work for a company where new career opportunities open as the organisation grows".

Hannah Harlock
Footwear Marketing Executive

For those graduates wishing to work towards professional registration, we provide support for Chartered registration to both the IET and IMechE with the help of existing Delcam Chartered Engineers.

While the majority of our graduate and placement opportunities are based at our Birmingham headquarters, as an international company with offices in over 80 countries, opportunities for travel soon arise for those that are interested.

For all disciplines you will gain experience of working on real world projects from your very first rotations. Putting it bluntly, at Delcam we've got too many exciting new opportunities and projects to have people making the tea!



► LIFE IN BIRMINGHAM

Birmingham has undergone a major renaissance in recent years and now offers a variety of attractions including one of the top European shopping centres, premier sports facilities, an extensive choice of restaurants, clubs and bars as well as being home of the world famous Birmingham Royal Ballet. We also have four first class theatres and a range of fascinating heritage buildings, museums and art galleries, and many fantastic live music venues.

Living and working in Birmingham

Although the city has been constantly changing and large amounts of redevelopment have already taken place and are continuing to do so, Birmingham also has a vast amount of green open spaces with 13.5 square miles of parkland, including Sutton Park, the largest urban park in Europe. Birmingham is also close to some of the most beautiful countryside in England including the Cotswolds, Malvern, Severn Valley and Cannock Chase.

Sport in Birmingham

If you love sport you can't go wrong with the Premier League and Nationwide League football, test match cricket, rugby, international tennis, golf and athletics that have their home in Birmingham. There are also many outdoor activities you can enjoy including mountain biking, walking, climbing, canoeing, sailing and much more.

How to get to Birmingham

The city is conveniently central to an extensive network of motorways and railways. Birmingham International Airport is 10 minutes away by train, while London is only a 90 minute train journey or a 2 hour drive.

You can find out more about living in Birmingham here:

www.delcam.com/livebrum



Delcam

Small Heath Business Park | Birmingham | B10 0HJ | UK
Tel: +44 (0) 121 766 5544 | Fax: +44 (0) 121 766 5511

www.delcam.com/graduates | www.delcam.tv/graduates

